



**ING. CESARE CARACCIOLLO**  
 VIA BARONDA, 1, I, 01  
 23823 - COLICO (LC)  
 Tel. 3335561443  
 e-mail cesarecaracciolo@libero.it

Comune di **Colico**

Provincia di **Lecco**

**Oggetto**  
 Opere di fondazione presso la nuova piazza  
 ecologica da realizzarsi in Colico (LC)

Parte d'opera **Opere di fondazione**

Committente

Tavola **3** **Plinti** **scala 1/50**

Il Progettista **ING. CESARE CARACCIOLLO**  
 Il Direttore dei Lavori **DA DEFINIRE**

Data **21/12/2020** Redazione Aggiornamento Procceduto

Il presente progetto è prodotto a numero di copie

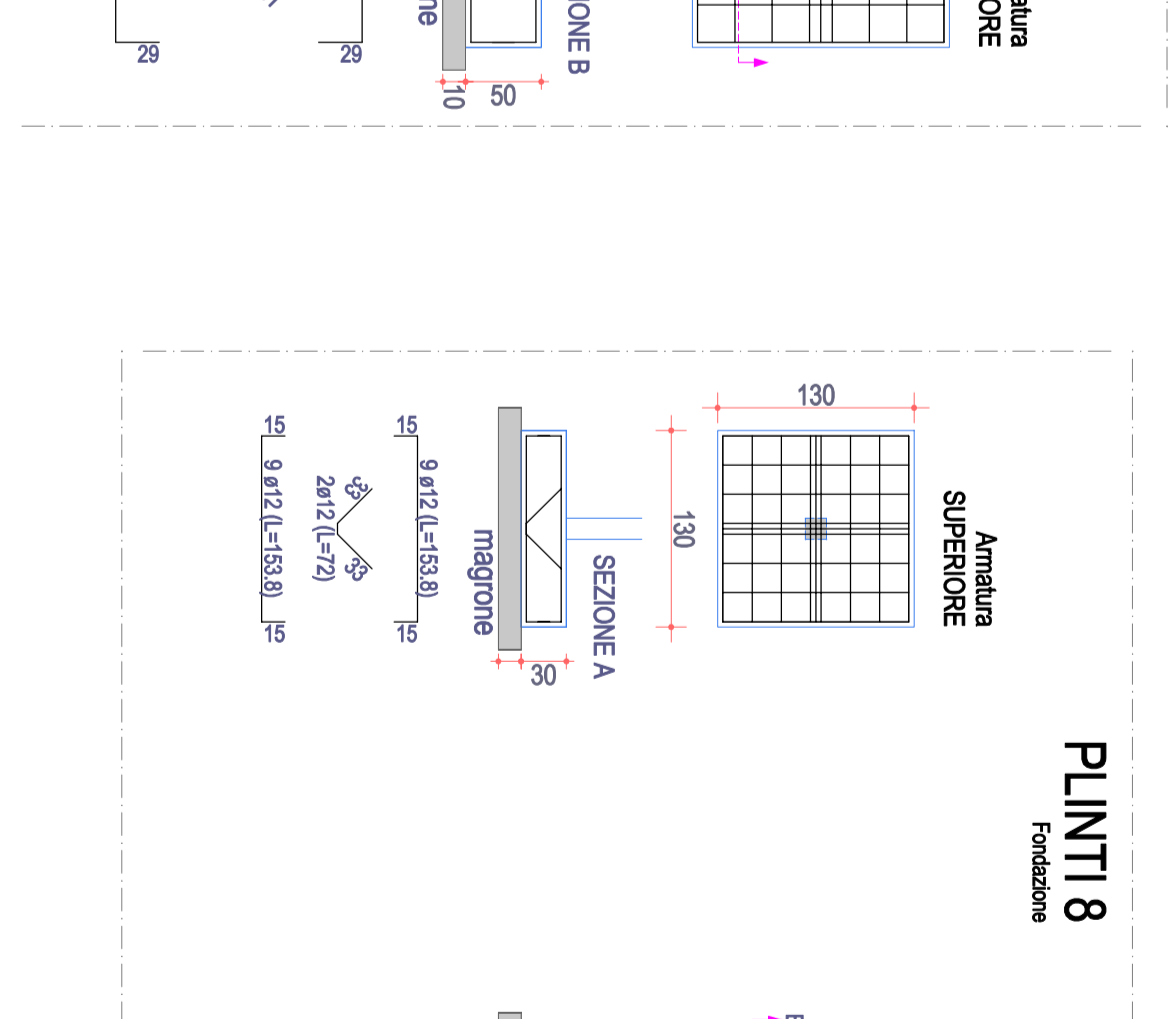
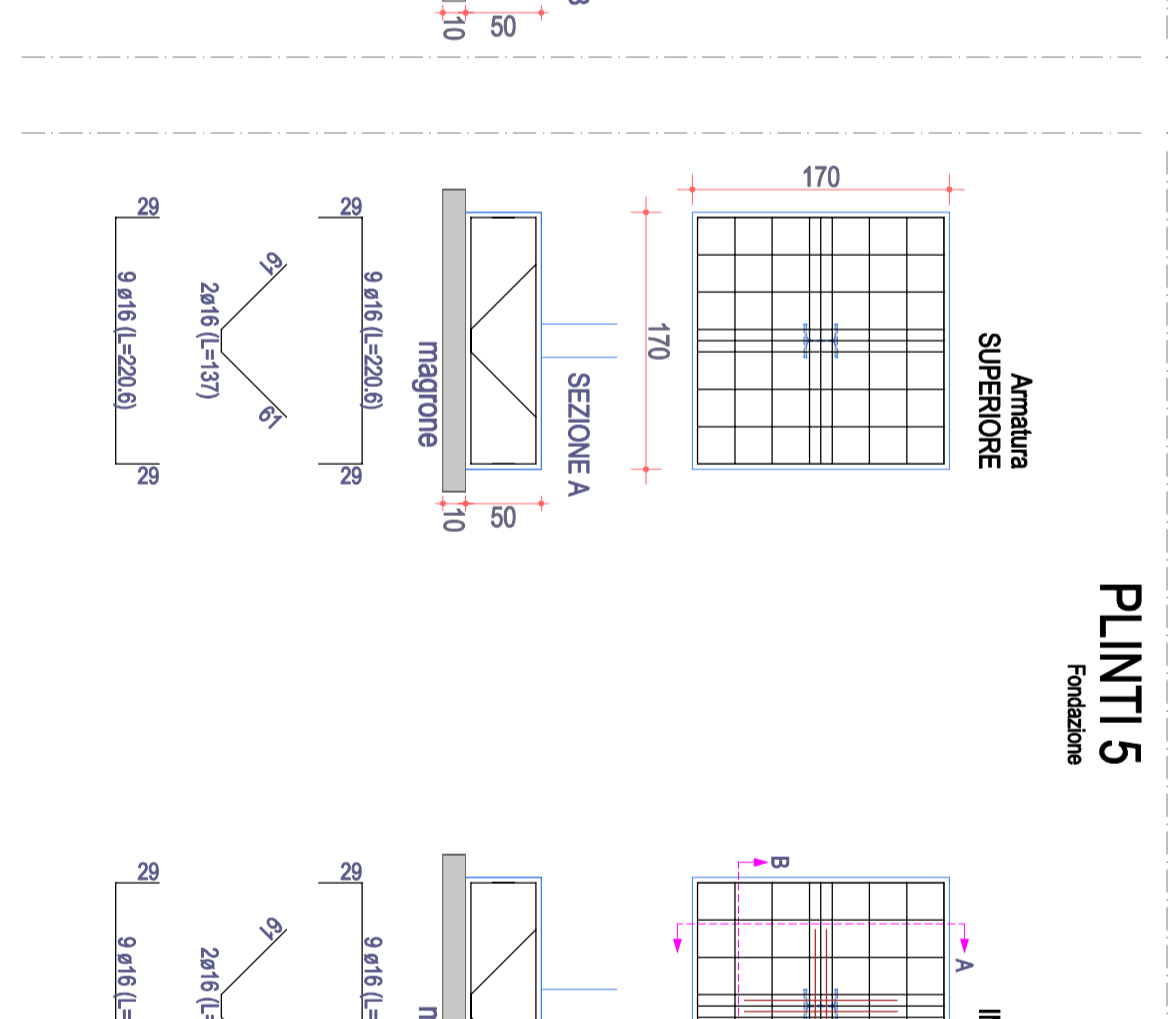
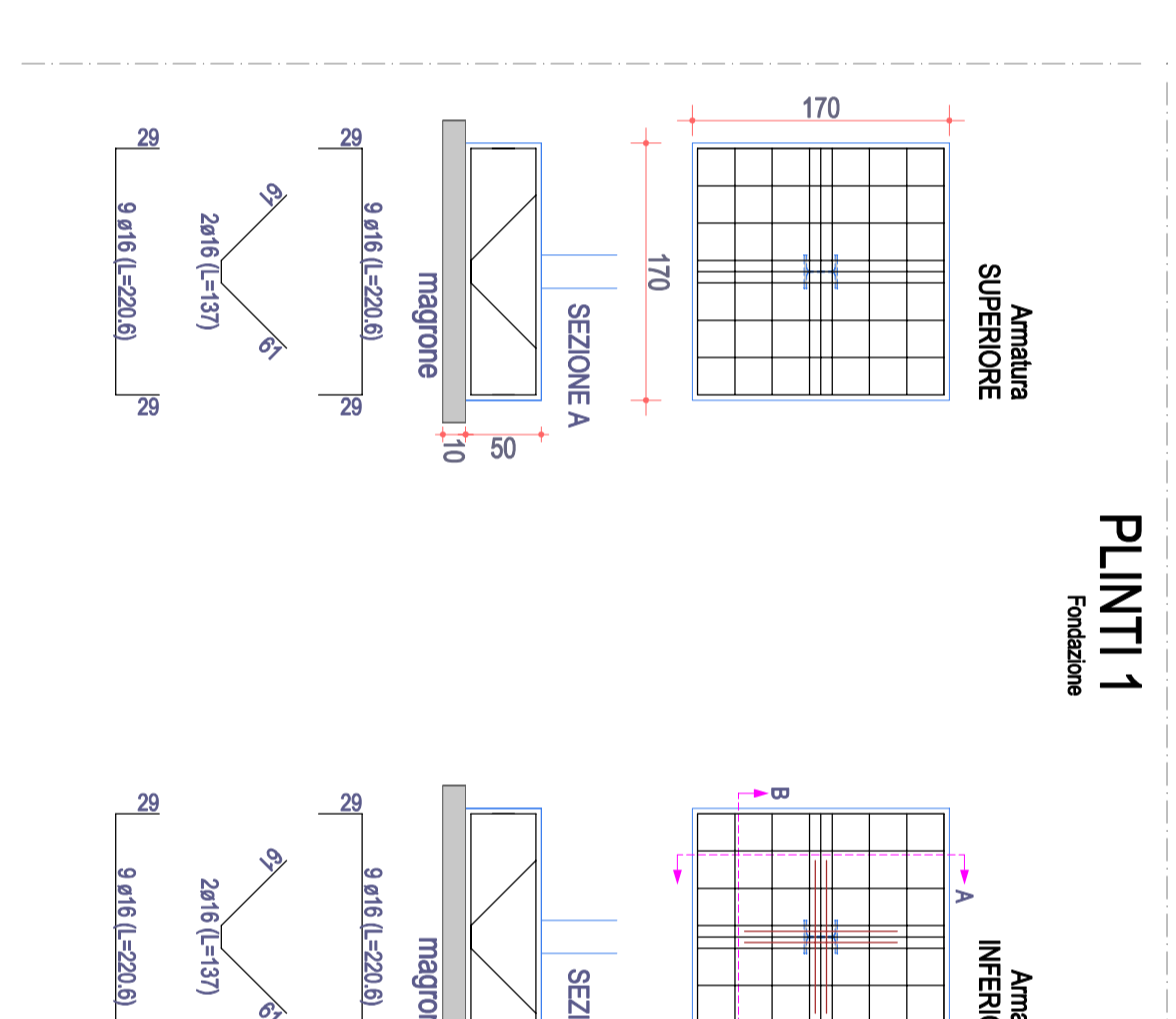
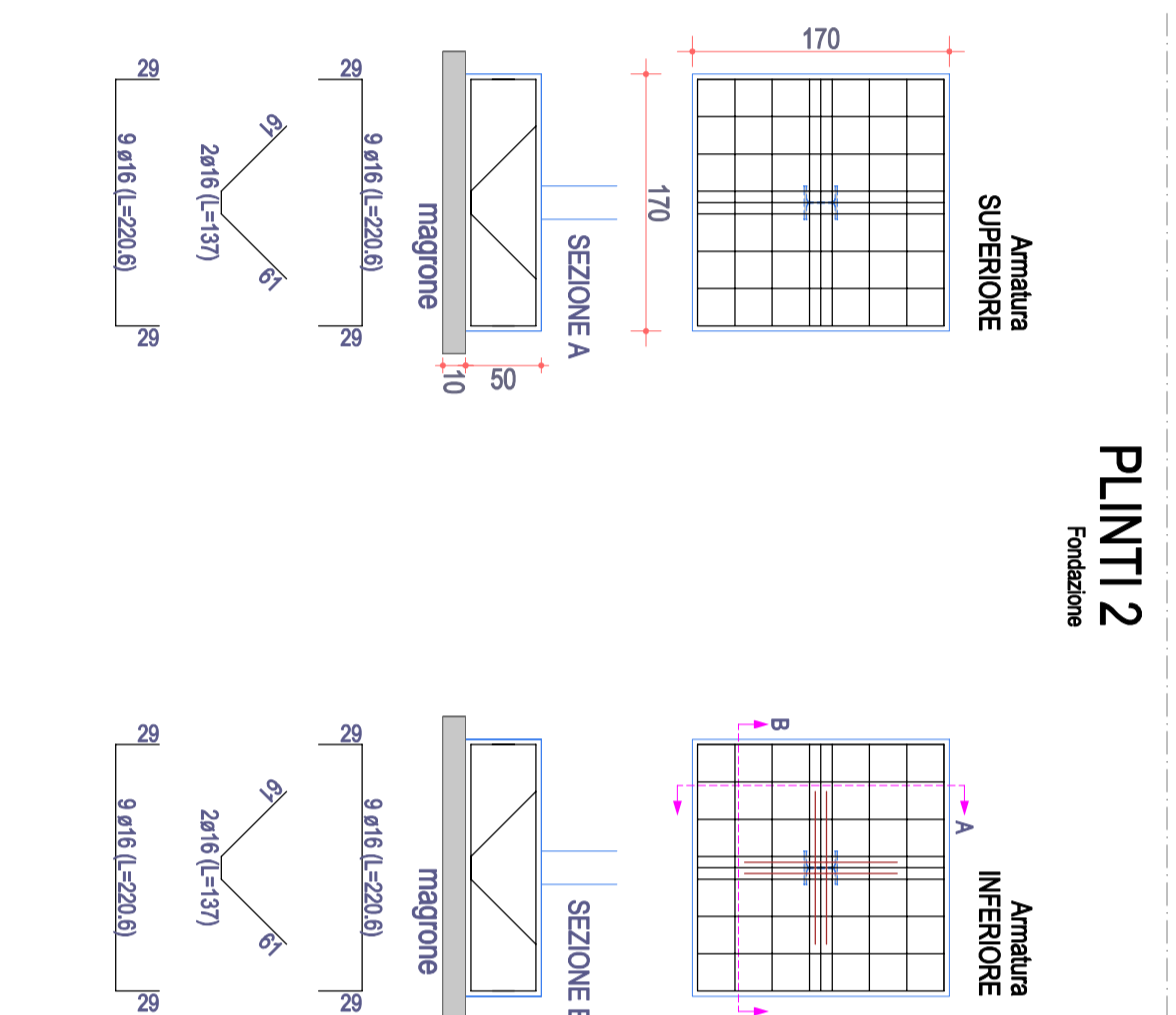
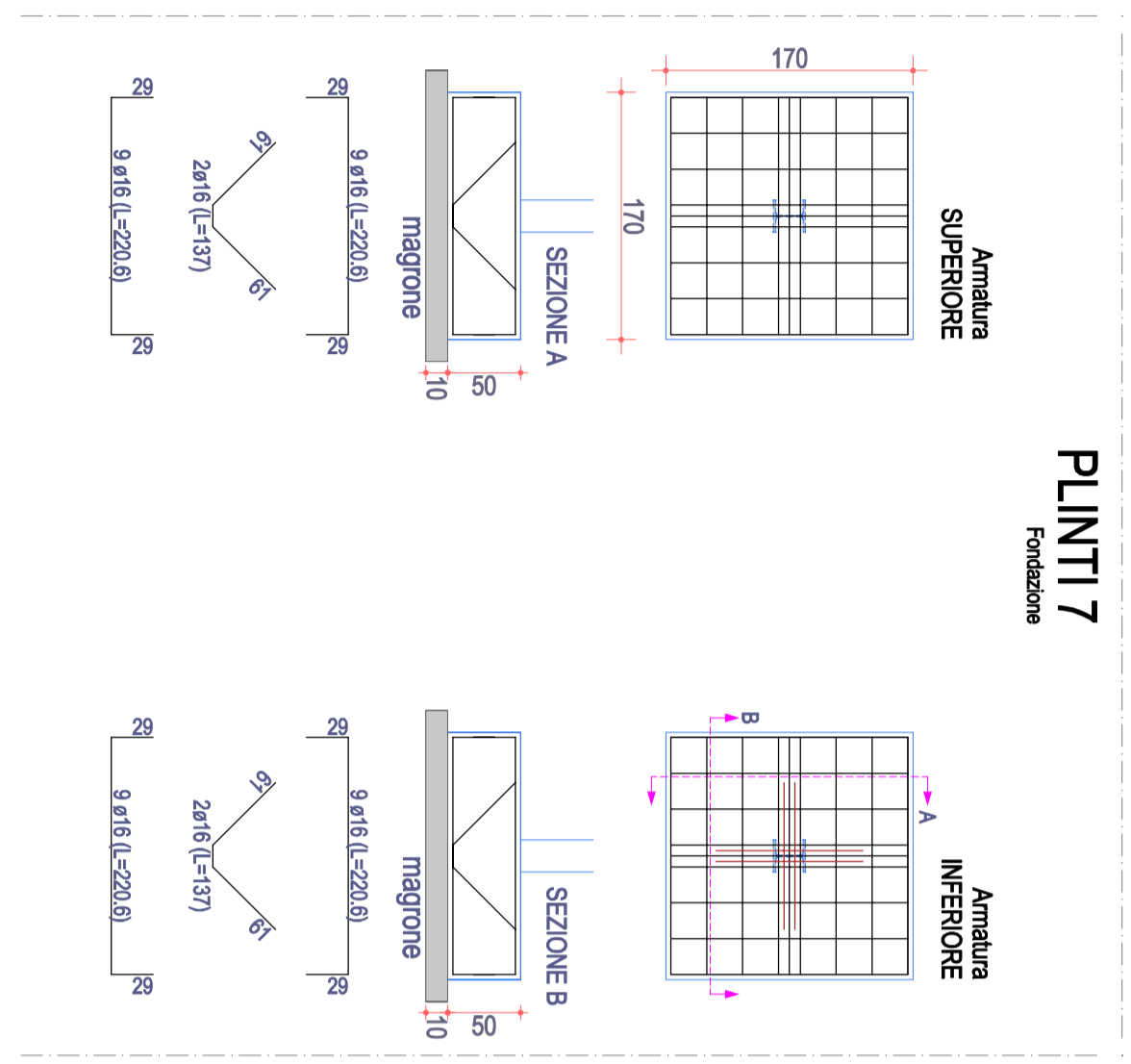
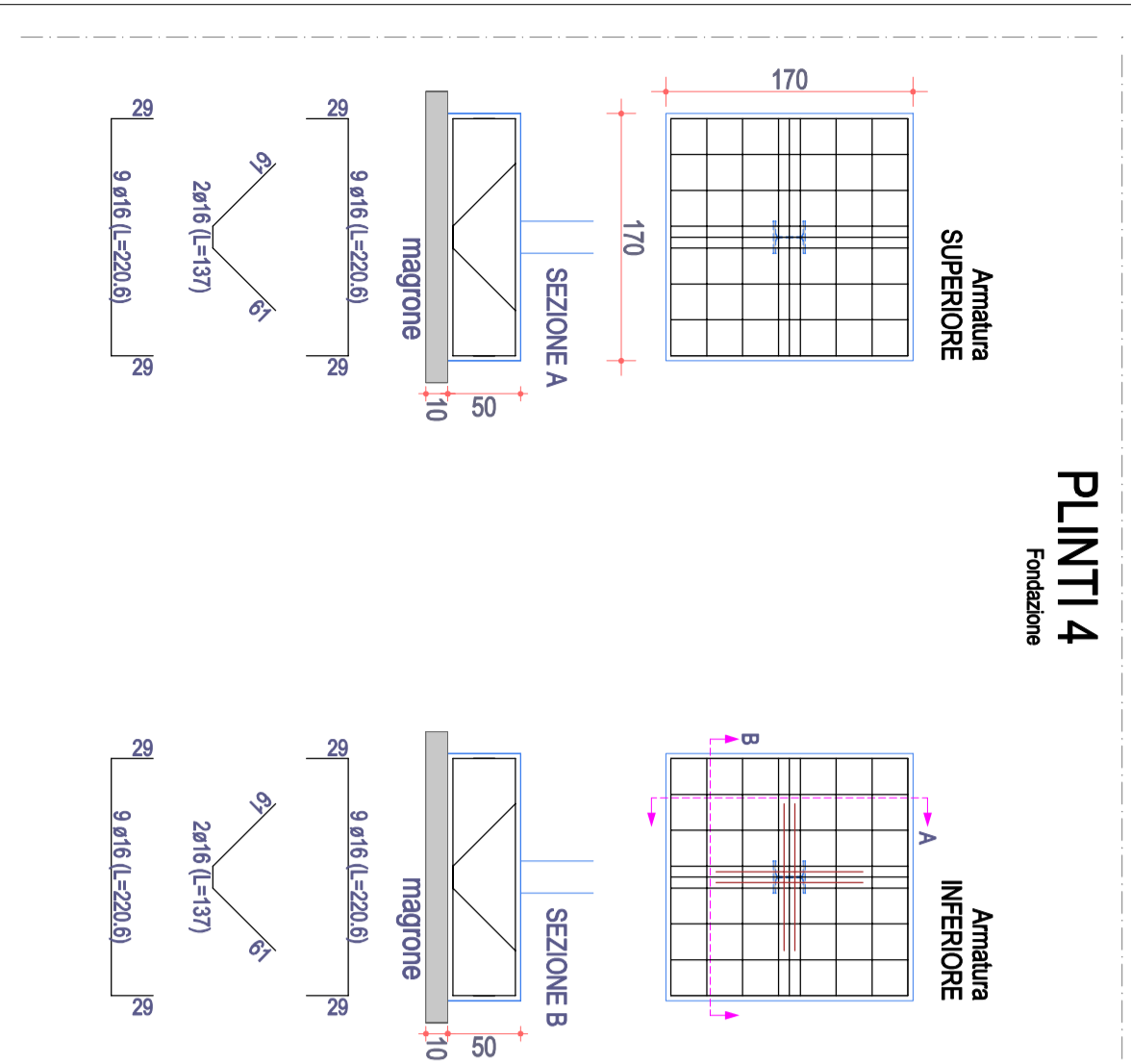
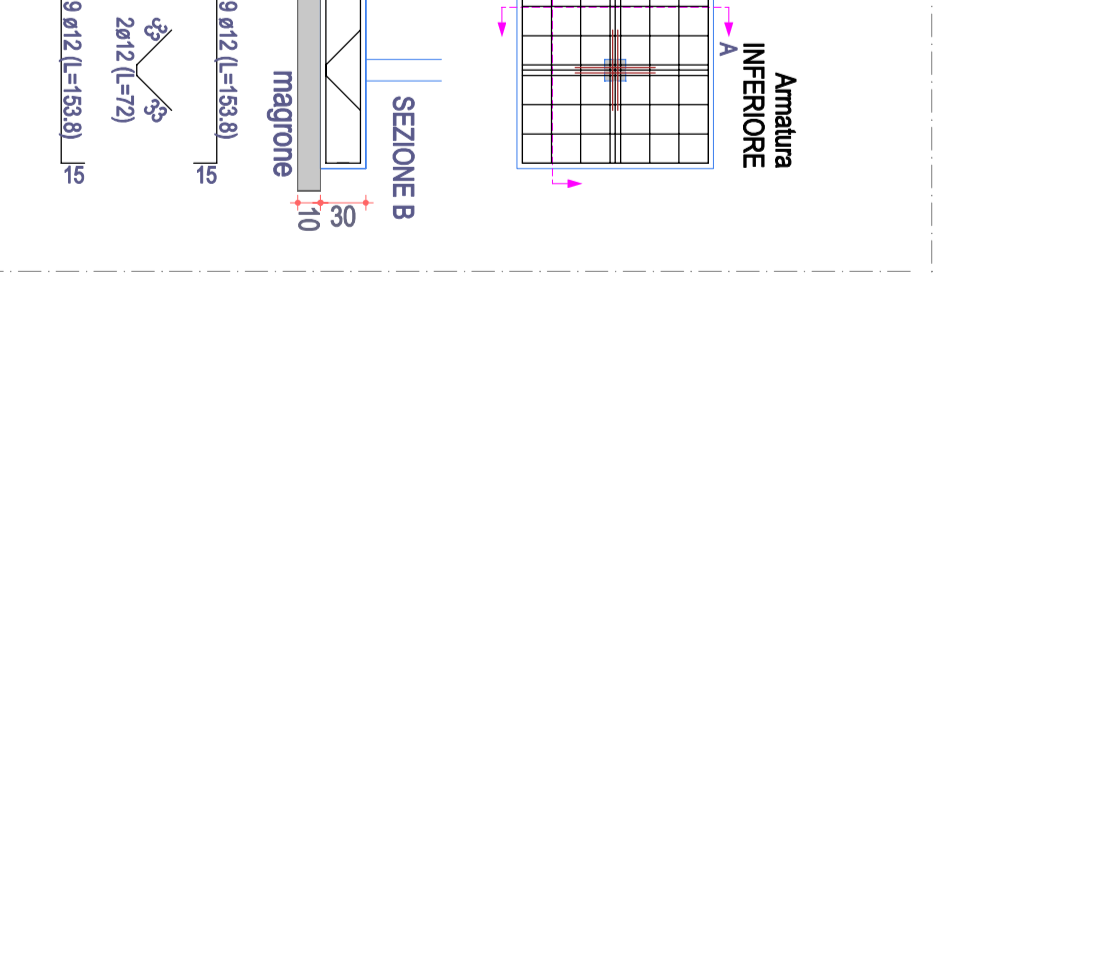
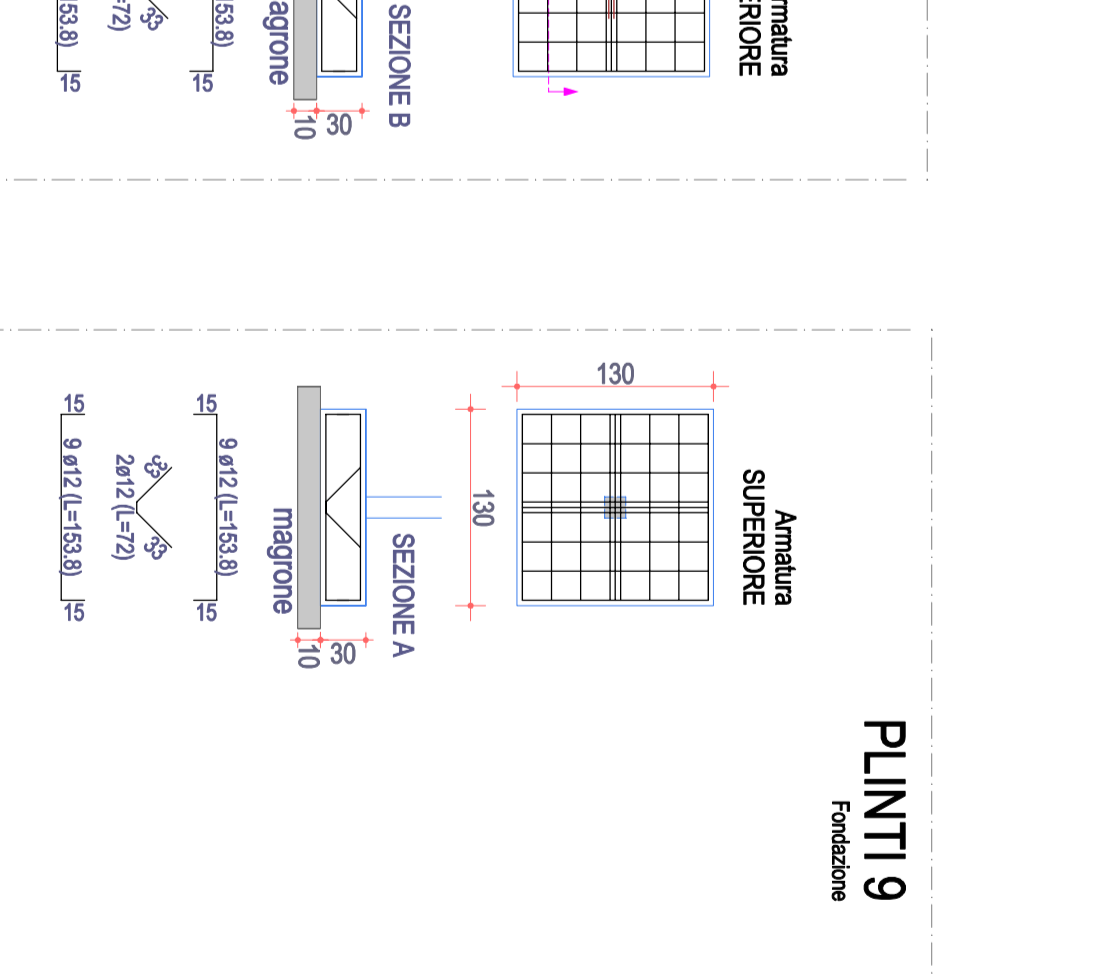
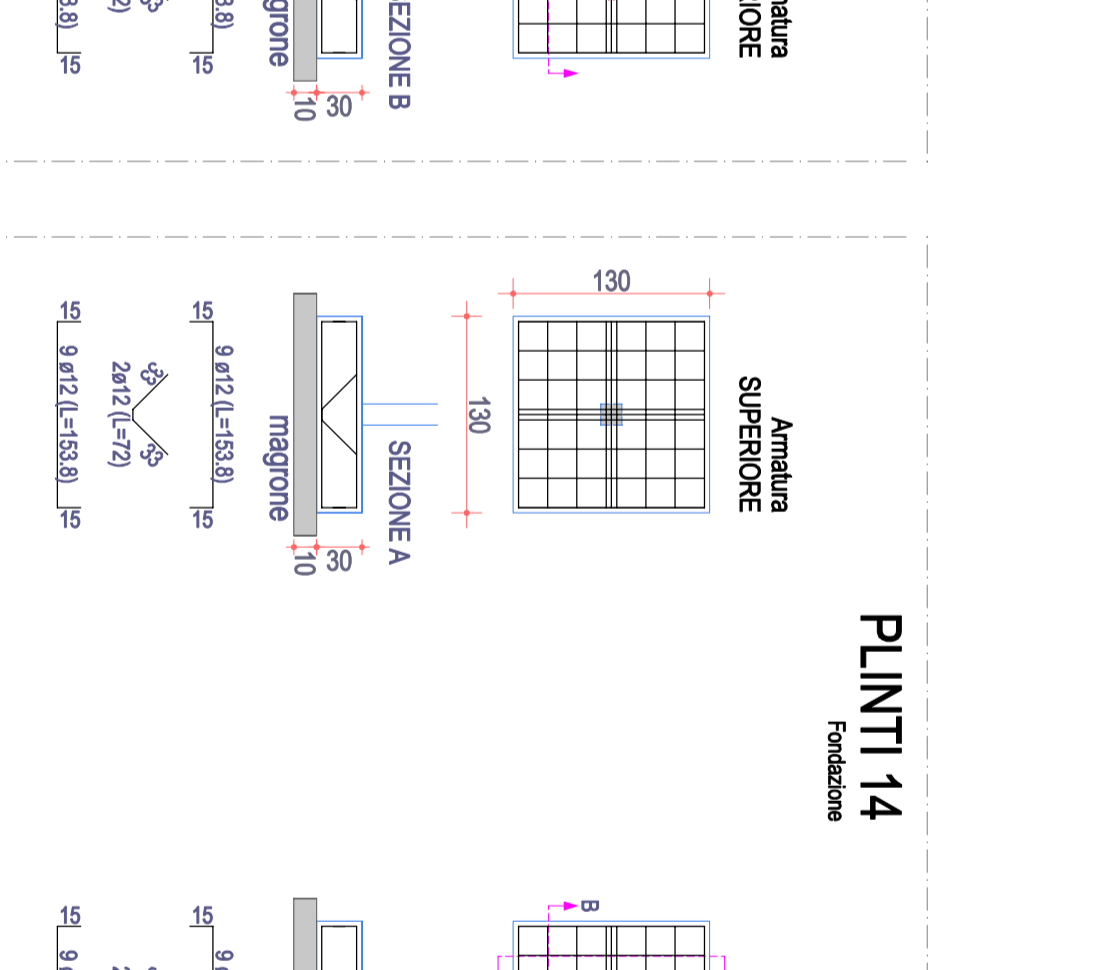
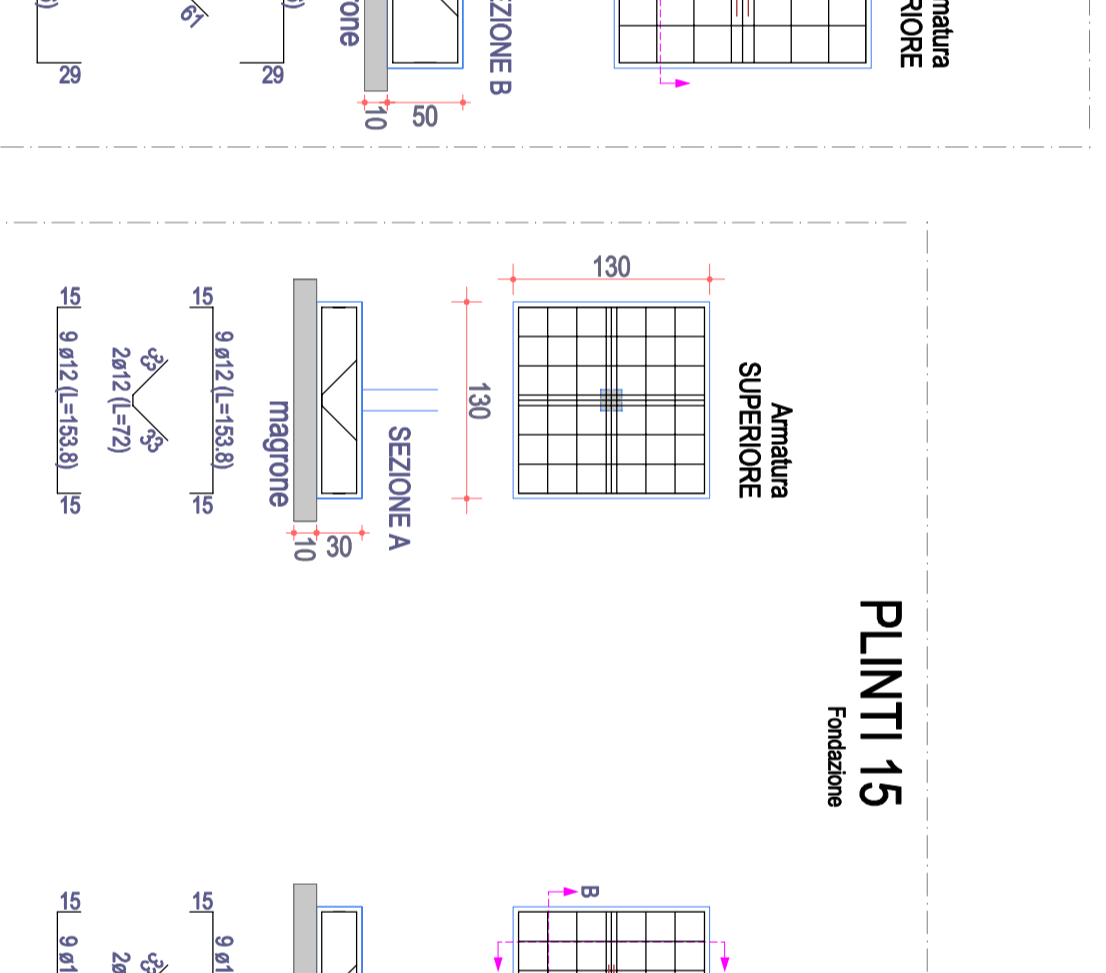
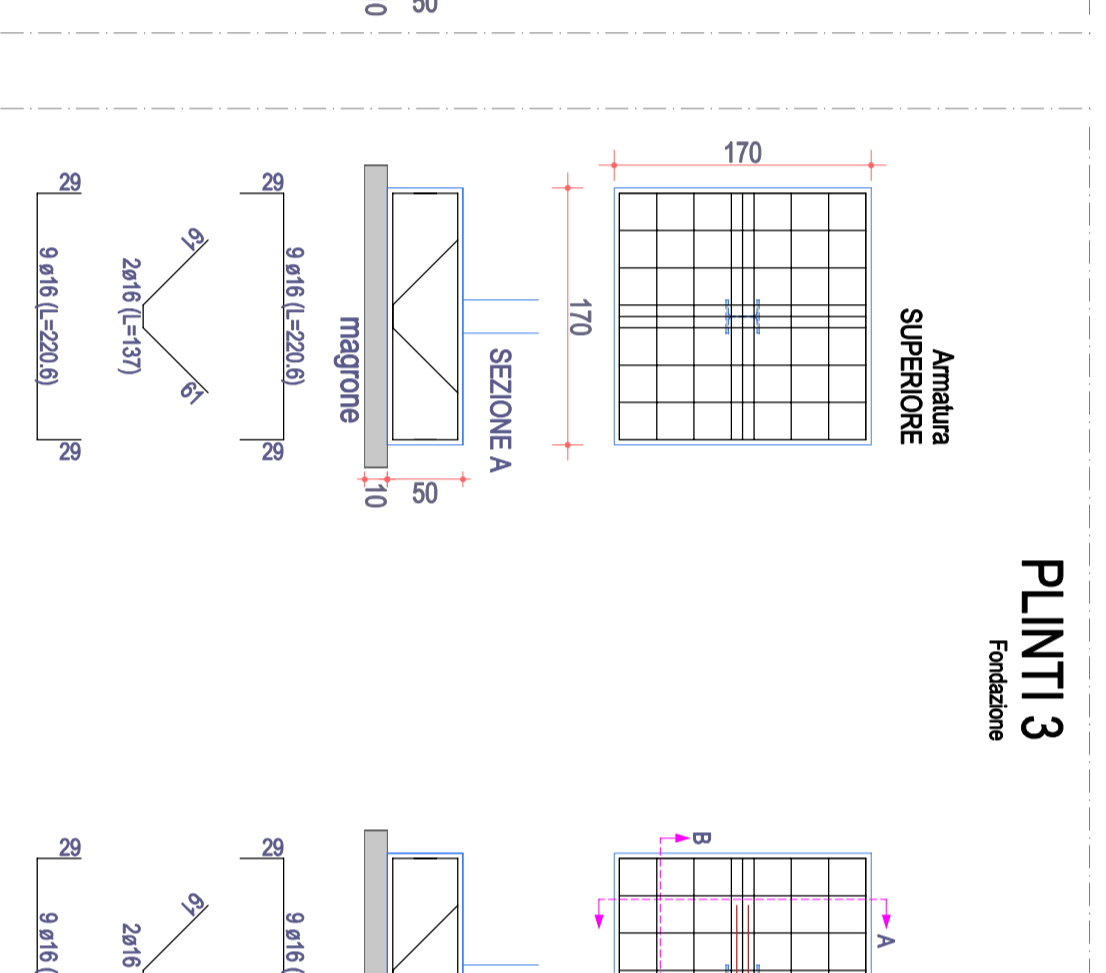
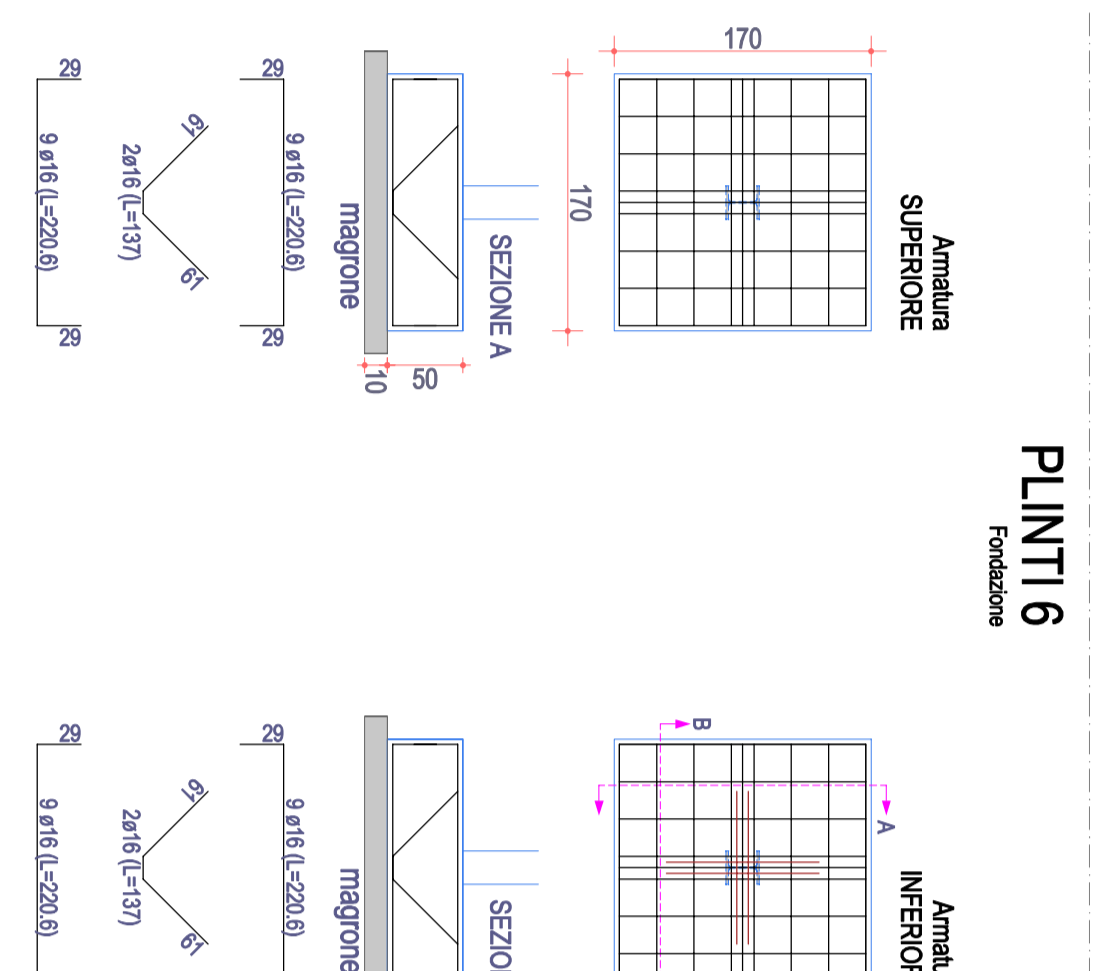
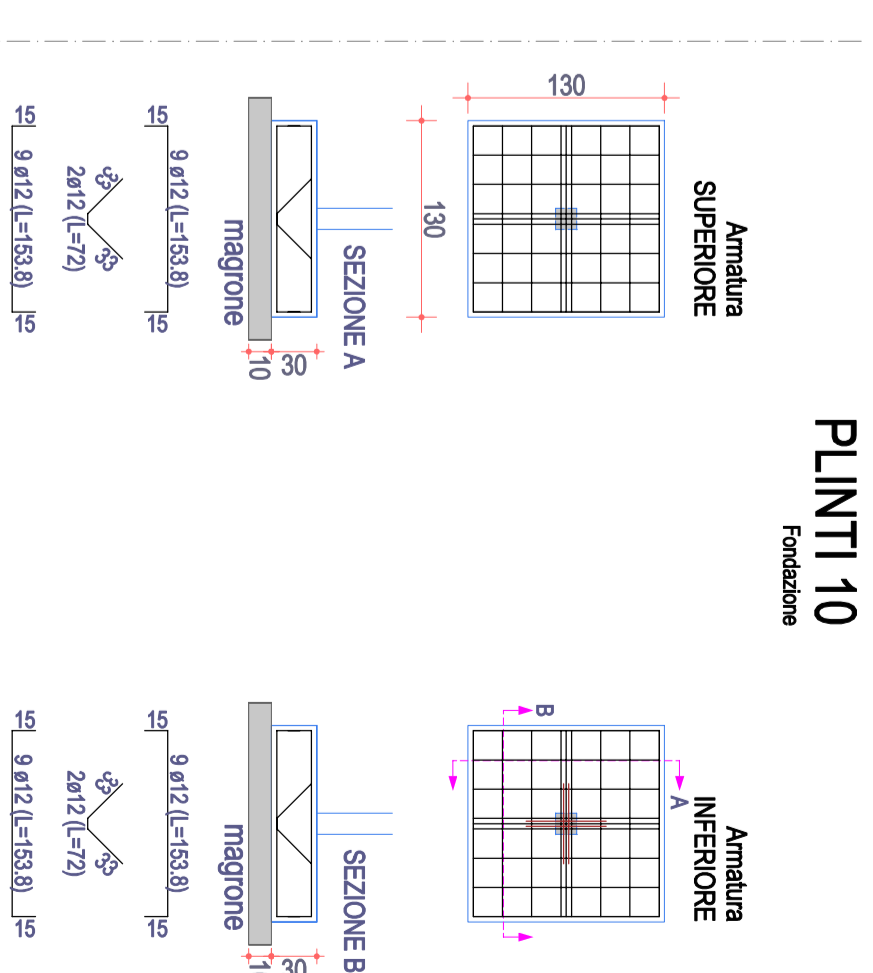
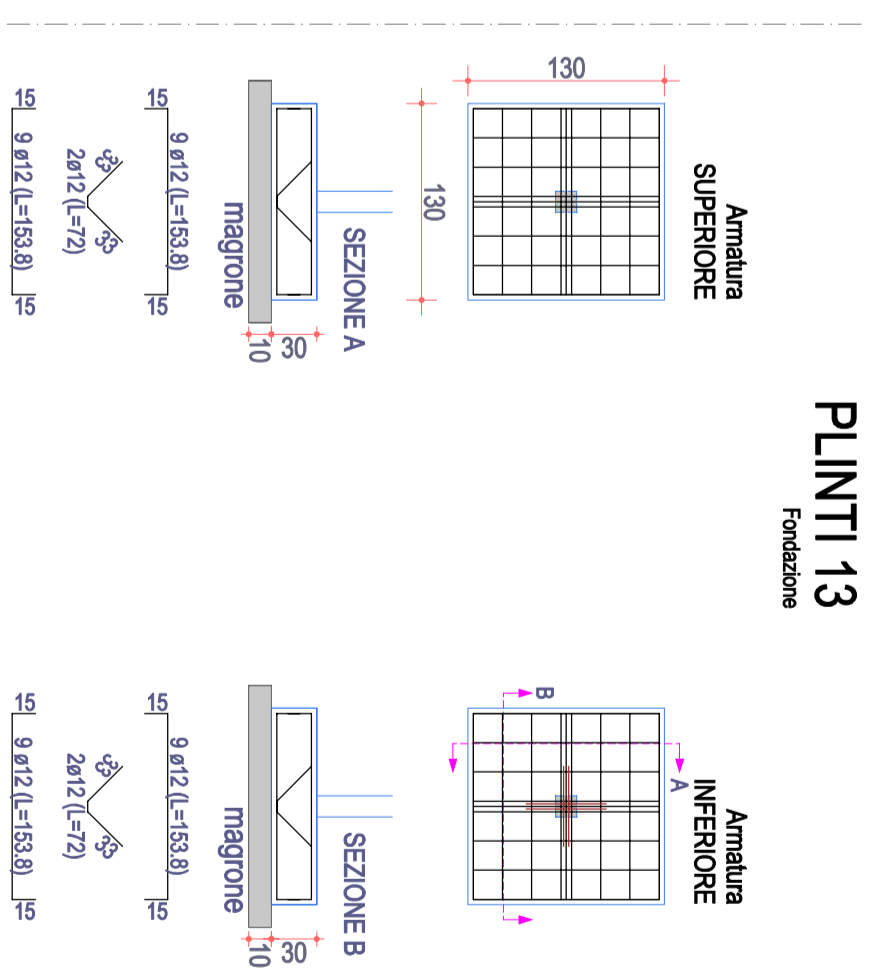
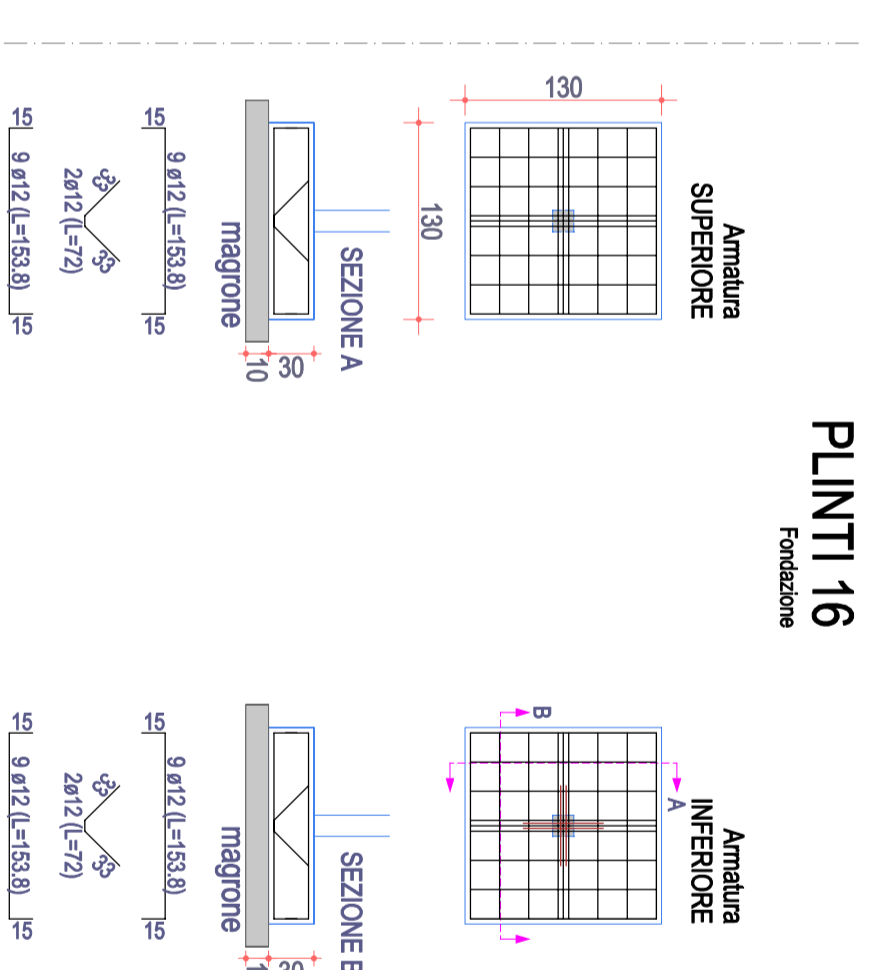
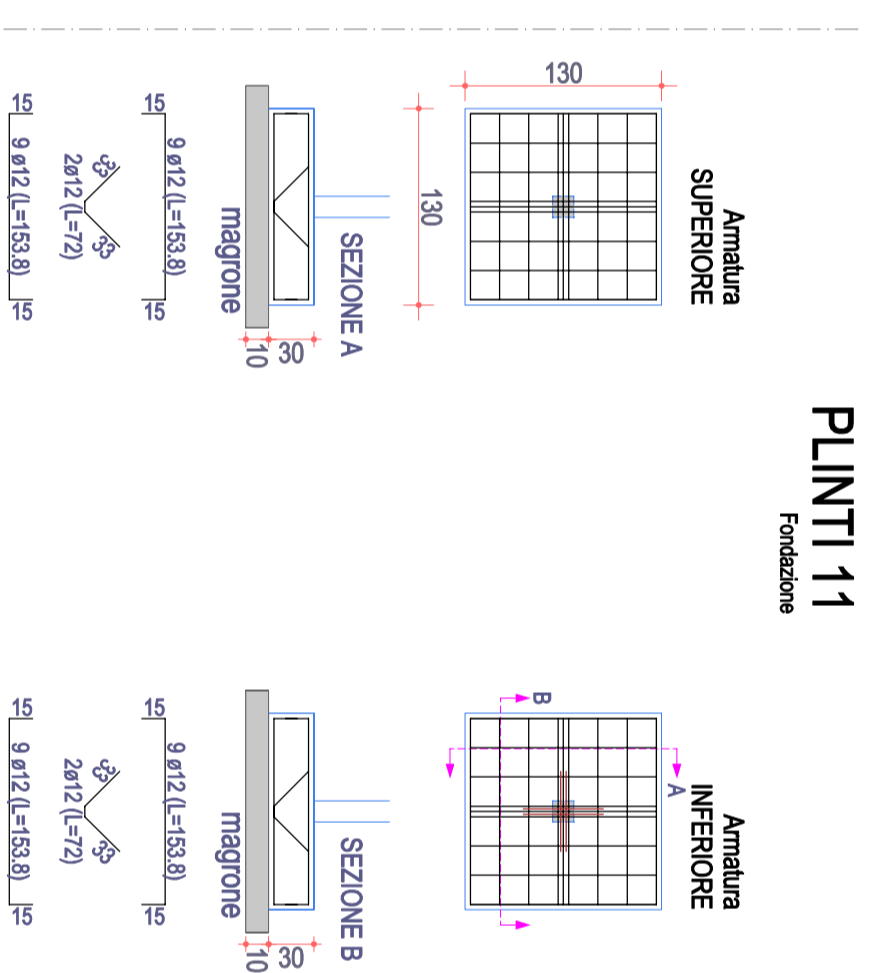
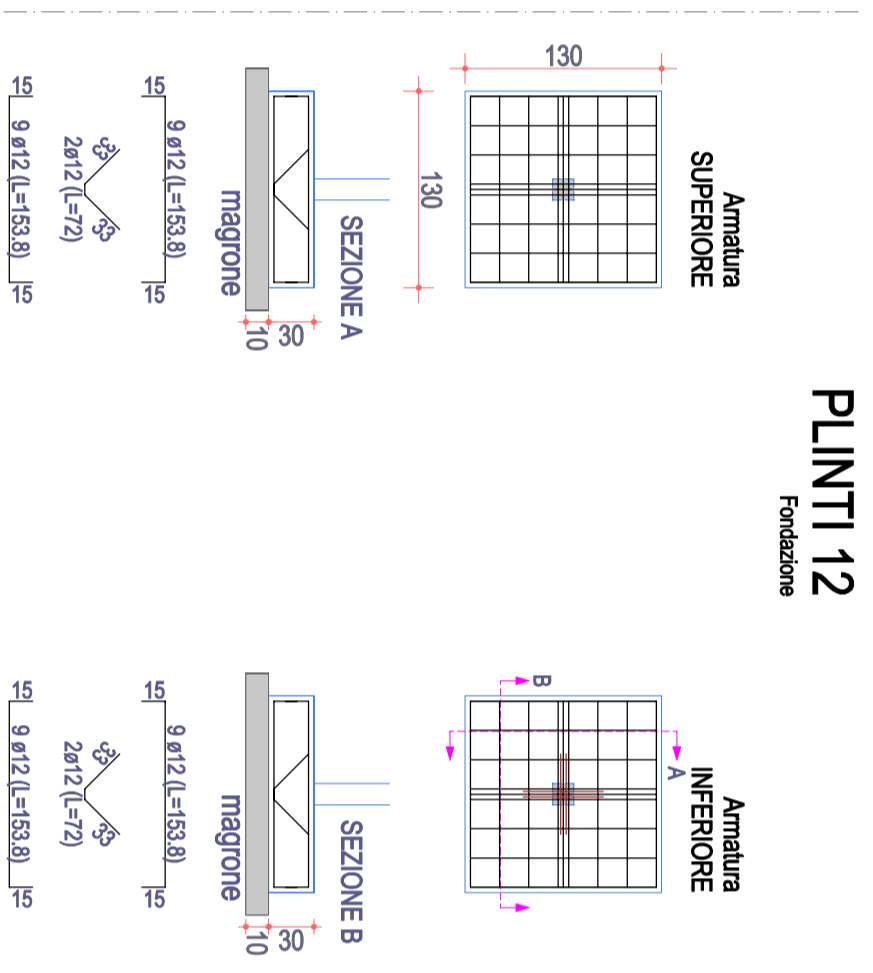
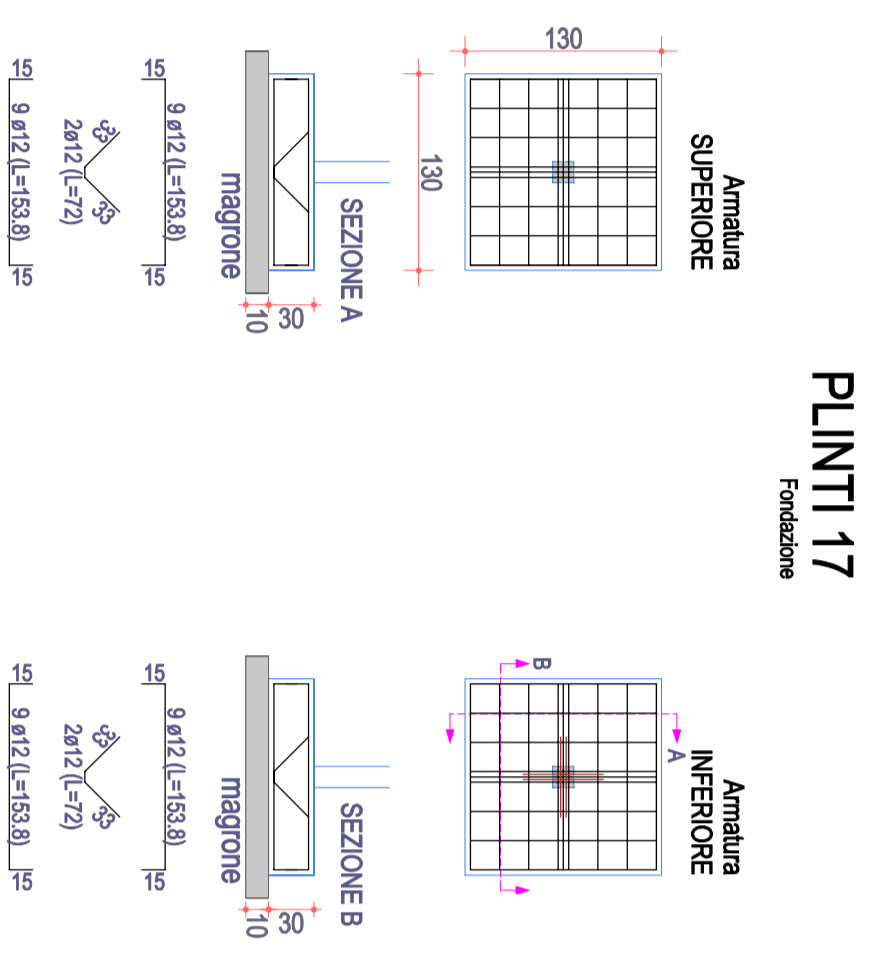

Classe di esposizione	Fond.	Elevazioni
Gruppo AC	XZ2	XZ2
Contorno esterno	CS2	CS2
Contorno interno cemento	CS3	CS3
Contorno interno	CS3	CS3
Classe di consistenza	S3	S3

**CARATTERISTICHE DEI MATERIALI:**  
 - Acciaio per opere c.a. a prestazione garantita stabilimento  
 - Calcestruzzo per opere c.a. a prestazione garantita (UNI EN 206-1)  
 (Diametro massimo aggregati 20mm.)

Scala: 1/50

Scala: 1/50

Scala: 1/50

Scala: 1/50

Scala: 1/50

Scala: 1/50

Scala: 1/50

Scala: 1/50

Scala: 1/50

Scala: 1/50

Scala: 1/50

Scala: 1/50

Scala: 1/50

Scala: 1/50

Scala: 1/50

Scala: 1/50

Scala: 1/50